

**DELAWARE COUNTY SOLID WASTE AUTHORITY**  
**MEETING**  
**ROSE TREE PARK**  
**August 16, 2023**  
**3:00 PM**

1. Call to Order
2. Roll Call
3. Pledge of Allegiance
4. **Approval** of the Minutes of the Board of Directors Meeting held at Rose Tree Park on June 21, 2023.
5. Public Comment
6. Report: Interim CEO, Jim Warner  
**Updates:** 6-month financial review, regional Authority financials, other
7. Facility Operations  
**Review:** July 2023 Tonnage Summary  
**Action Item with Issue Paper:** Rolling Hills Landfill Change Order
8. Accounting and Finance  
**Review:** July 2023 and YTD Operating and Capital Budget Report  
**Action Item:** Approval of the Accounts Payable List for June and July 2023
9. Strategic Planning, Administration and Policy  
**Action Item with Issue Paper:** Approve Exclusive Negotiations with NextEra Energy  
**Action Item with Issue Paper:** Approve SCS Services as Transfer Station Consultant  
**Action Item:** Authorize Electronic Signature of Board Chair and Treasurer to PADEP Recycling Grant Submission  
**Action Item with Issue Paper:** Approve purchase of furniture from Office Basics  
**Review:** RFP for Local Engineering Firm for Land Development Services for Transfer Stations
10. Other Business
11. Solicitor Report  
**Review:** meeting with county officials re: delegation agreement, waste management code revisions
12. Adjournment
13. Executive Session: personnel

**DELAWARE COUNTY SOLID WASTE AUTHORITY**  
**Rose Tree Park**  
**June 21, 2023**

The meeting was called to order at 3:00 PM.

The pledge of Allegiance was said.

Roll Call

Board Member Attendance:            James McLaughlin, Chairman  
   William Silverstein, Vice Chairman  
   William Jones, Secretary  
   Steven Goldfield, Treasurer/Asst. Secretary  
   James P. Kelly, Member  
   John Butler, Member  
   Christine Reuther, Ex-Officio  
   Don Vymazal, Ex-Officio

Others In attendance:                James Warner, Interim CEO  
   Michael Clarke, Solicitor  
   Samantha Newell, Solicitor  
   Jeff Munster, COO  
   Wendy Marburger, CAO  
   Angel Nash, Accounting Manager

Upon motion duly made and seconded, and by unanimous vote **Approval** of the Minutes of the Board of Directors Meeting held at Rose Tree Park on May 17, 2023. Motion made by James Kelly Seconded by Steven Goldfield; motion was passed with no dissenting votes.

Jim Warner, Interim CEO updates on:

- Landfill Gas RFP Responses
- Delco Sustainability Conference
- Waste Management Fuel Prices
- Purchase of a drone for the Landfill

May 2023 Tonnage Summary reviewed.

Rolling Hills Landfill multiple project photo update.

Upon motion duly made and seconded, and by unanimous vote **Approval** for Purchase of Security Cameras from KIT Communications (Verkada Cameras) as the security camera provider for \$ 24,693 for Rolling Hills Landfill Motion made by John Butler; Seconded by William Silverstein, motion was passed with no dissenting votes.

Upon motion duly made and seconded, and by unanimous vote **Approval** to Award Paving and Tar and Chip Bids at Rolling Hills Landfill to Kinsley Construction for \$ 1,159,498 and the Tar & Chip Project to the HAK Group for \$ 35,890. Motion made by James Kelly; Seconded by Steven Goldfield, motion was passed with no dissenting votes.

May 2023 and YTD Operating and Capital Budget reviewed and discussed.

Upon motion duly made and seconded, and by unanimous vote **Approval** of Payment of Bills For the month of May 2023. Motion made by Steven Goldfield; Seconded by James Kelly, motion was passed with no dissenting votes.

Upon motion duly made and seconded, and by unanimous vote **Approval** of Employee and Pension/Retirement Plans. Motion made by Steven Goldfield; Seconded by William Silverstein, motion was passed with no dissenting votes.

Solicitor: No Report

The Delaware County Solid Waste Authority Board held an Executive Session at the Workshop Meeting held on June 14, 2023 to discuss Personnel.

There being no further business, the meeting was adjourned at 4:08 PM.

The Delaware County Solid Waste Authority Board went into Executive Session.

DELAWARE COUNTY SOLID WASTE AUTHORITY

2022 vs 2023

JAN - JUN

OPERATING BUDGET SUMMARY

|                                    | <u>2022</u>       | <u>2023</u>       | <u>Variance</u>  | <u>Variance %</u> |
|------------------------------------|-------------------|-------------------|------------------|-------------------|
| <b>REVENUE</b>                     |                   |                   |                  |                   |
| Delco Residential                  | 5,757,424         | 6,573,779         | 816,355          | 14%               |
| Delco Commercial                   | 4,728,832         | 5,062,917         | 334,085          | 7%                |
| Delco Direct Residential           | 2,538,549         | 2,213,296         | (325,253)        | -13%              |
| Delco Direct Commercial            | 1,809,762         | 2,059,951         | 250,189          | 14%               |
| Covanta Ash                        | 3,474,197         | 3,994,342         | 520,145          | 15%               |
| Plymouth Ash                       | 498,627.00        | 406,703           | (91,924)         | -18%              |
| Berks County                       | 1,055,146.00      | 2,255,766         | 1,200,620        | 114%              |
| Montgomery County                  | 3,103,895.00      | 2,658,033         | (445,862)        | -14%              |
| Residual                           | 168,080           | 1,355,463         | 1,187,383        | 706%              |
| Grants                             | 0                 | 174,106           | 174,106          |                   |
| Miscellaneous                      | 72,108            | 255,838           | 183,730          | 255%              |
| <b>Total Revenue</b>               | <b>23,206,620</b> | <b>27,010,194</b> | <b>3,803,574</b> | <b>16%</b>        |
| Discounts                          | 443,860           | 482,249           | 38,389           | 9%                |
| <b>Total Net Revenue</b>           | <b>22,762,760</b> | <b>26,527,945</b> | <b>3,765,185</b> | <b>17%</b>        |
| <b>EXPENSES</b>                    |                   |                   |                  |                   |
| Administration                     | 1,287,975         | 1,278,645         | (9,330)          | -1%               |
| Operations                         | 2,449,580         | 2,630,831         | 181,251          | 7%                |
| Contract Hauling                   | 4,009,126         | 4,859,265         | 850,139          | 21%               |
| Covanta Processing                 | 8,155,957         | 7,628,240         | (527,717)        | -6%               |
| Delco Host Fees                    | 363,274           | 341,473           | (21,801)         | -6%               |
| RHL Host Fees                      | 1,827,973         | 2,258,975         | 431,002          | 24%               |
| HHW Events/Recycling               | 52,382            | 18,901            | (33,481)         | -64%              |
| <b>Total Expenses</b>              | <b>18,146,267</b> | <b>19,016,329</b> | <b>870,062</b>   | <b>5%</b>         |
| <b>Debt P &amp; I Payments</b>     | <b>368,300</b>    | <b>365,700</b>    | <b>(2,600)</b>   | <b>-1%</b>        |
| <b>Operating Surplus (Deficit)</b> | <b>4,248,193</b>  | <b>7,145,916</b>  | <b>2,897,723</b> | <b>68%</b>        |

**2023 BUDGET SUMMARY BY LOCATION**  
**JANUARY TO JUNE**

|                       | DELCO                | %          | \$/T           | ROLLING<br>HILLS     | %          | \$/T           | TOTAL                | \$/T            |
|-----------------------|----------------------|------------|----------------|----------------------|------------|----------------|----------------------|-----------------|
| <b>TONNAGE</b>        | <b>192,503</b>       |            |                | <b>326,074</b>       |            |                | <b>518,577</b>       |                 |
| OPS REVENUE           | \$ 15,427,694        | 62%        | \$80.14        | \$ 9,314,844         | 38%        | \$28.57        | \$ 24,742,538        | \$ 47.71        |
| OTHER & NON-OPS       | \$ 535,622           | 30%        | \$ 2.78        | \$ 1,249,785         | 70%        | \$ 3.83        | \$ 1,785,407         | \$ 3.44         |
|                       | <b>\$ 15,963,316</b> | <b>60%</b> | <b>\$82.92</b> | <b>\$ 10,564,629</b> | <b>40%</b> | <b>\$32.40</b> | <b>\$ 26,527,945</b> | <b>\$ 51.16</b> |
| OPERATIONS            | \$ 13,303,263        | 75%        | \$69.11        | \$ 4,434,421         | 25%        | \$13.60        | \$ 17,737,684        | \$ 34.20        |
| ADMIN                 | \$ 319,661           | 25%        | \$ 1.66        | \$ 958,984           | 75%        | \$ 2.94        | \$ 1,278,645         | \$ 2.47         |
| TOTAL EXPENSES        | <b>\$ 13,622,924</b> | <b>72%</b> | <b>\$70.77</b> | <b>\$ 5,393,405</b>  | <b>28%</b> | <b>\$16.54</b> | <b>\$ 19,016,329</b> | <b>\$ 36.67</b> |
| NET OPERATING INCOME  | <b>\$ 2,340,392</b>  | <b>31%</b> | <b>\$12.16</b> | <b>\$ 5,171,224</b>  | <b>69%</b> | <b>\$15.86</b> | <b>\$ 7,511,616</b>  | <b>\$ 14.49</b> |
| CONTRIBUTION MARGIN   | <b>14.7%</b>         |            |                | <b>48.9%</b>         |            |                |                      |                 |
| DEBT P&I              |                      |            |                |                      |            |                | \$ (365,700)         |                 |
| NET OPERATING SURPLUS |                      |            |                |                      |            |                | <b>\$ 7,145,916</b>  |                 |

+43%

+11.3%

\$430/ton

**2022 BUDGET SUMMARY BY LOCATION  
JANUARY TO JUNE**

|                       | DELCO                |            |                | ROLLING HILLS       |            |                | TOTAL                |                 |
|-----------------------|----------------------|------------|----------------|---------------------|------------|----------------|----------------------|-----------------|
|                       |                      | %          | \$/T           |                     | %          | \$/T           |                      | \$/T            |
| <b>TONNAGE</b>        | <b>188,647</b>       |            |                | <b>264,522</b>      |            |                | <b>453,169</b>       |                 |
| OPS REVENUE           | \$ 14,390,707        | 64%        | \$76.28        | \$ 8,131,865        | 36%        | \$30.74        | \$ 22,522,572        | \$ 49.70        |
| OTHER & NON-OPS       | \$ 72,057            | 30%        | \$ 0.38        | \$ 168,134          | 70%        | \$ 0.64        | \$ 240,191           | \$ 0.53         |
|                       | <b>\$ 14,462,764</b> | <b>64%</b> | <b>\$76.67</b> | <b>\$ 8,299,999</b> | <b>36%</b> | <b>\$31.38</b> | <b>\$ 22,762,763</b> | <b>\$ 50.23</b> |
| OPERATIONS            | \$ 12,643,719        | 75%        | \$67.02        | \$ 4,214,573        | 25%        | \$15.93        | \$ 16,858,292        | \$ 37.20        |
| ADMIN                 | \$ 321,994           | 25%        | \$ 1.71        | \$ 965,981          | 75%        | \$ 3.65        | \$ 1,287,975         | \$ 2.84         |
| TOTAL EXPENSES        | <b>\$ 12,965,713</b> | <b>71%</b> | <b>\$68.73</b> | <b>\$ 5,180,554</b> | <b>29%</b> | <b>\$19.58</b> | <b>\$ 18,146,267</b> | <b>\$ 40.04</b> |
| NET OPERATING INCOME  | <b>\$ 1,497,052</b>  | <b>32%</b> | <b>\$ 7.94</b> | <b>\$ 3,119,444</b> | <b>68%</b> | <b>\$11.79</b> | <b>\$ 4,616,496</b>  | <b>\$ 10.19</b> |
| CONTRIBUTION MARGIN   | <b>10.4%</b>         |            |                | <b>37.6%</b>        |            |                |                      |                 |
| DEBT P&I              |                      |            |                |                     |            |                | <b>\$ (368,300)</b>  |                 |
| NET OPERATING SURPLUS |                      |            |                |                     |            |                | <b>\$ 4,248,196</b>  |                 |

SEE NEXT PAGE FOR  
MARGIN IMPROVEMENT IN 2023

**DELAWARE COUNTY SOLID WASTE AUTHORITY**

**2022 vs 2023**

**JAN - JUN**

**TONNAGE SUMMARY**

|                          | <u>2022</u><br><u>TONS</u> | <u>2023</u><br><u>TONS</u> | <u>Variance</u> | <u>Variance %</u> |
|--------------------------|----------------------------|----------------------------|-----------------|-------------------|
| Delaware County Refuse   |                            |                            |                 |                   |
| Delco Residential        | 73,813                     | 79,152                     | 5,339           | 7%                |
| Delco Commercial         | 59,110                     | 60,927                     | 1,817           | 3%                |
| Delco Direct Residential | 33,000                     | 27,303                     | (5,697)         | -17%              |
| Delco Direct Commercial  | 22,724                     | 25,121                     | 2,397           | 11%               |
| <b>Total Tons</b>        | <b>188,647</b>             | <b>192,503</b>             | <b>3,856</b>    | <b>2%</b>         |
| Rolling Hills Landfill   |                            |                            |                 |                   |
| Covanta Ash              | 166,398                    | 192,571                    | 26,173          | 16%               |
| Plymouth Ash             | 22,801                     | 18,462                     | (4,339)         | -19%              |
| Berks County             | 18,277                     | 40,774                     | 22,497          | 123%              |
| Montgomery County        | 53,814                     | 44,433                     | (9,381)         | -17%              |
| Residual                 | 3,232                      | 29,834                     | 26,602          | 823%              |
| <b>Total Tons</b>        | <b>264,522</b>             | <b>326,074</b>             | <b>61,552</b>   | <b>23%</b>        |
| <b>System Tons</b>       | <b>453,169</b>             | <b>518,577</b>             | <b>65,408</b>   | <b>14%</b>        |
| <b>Delco Tons to RHL</b> | <b>0</b>                   | <b>20,845</b>              | <b>20,845</b>   |                   |



# Regional Public Waste Authority Financials

as of 12/31/22

|                      | Revenue  | Tons of Waste | Long Term Debt | Net Position |
|----------------------|----------|---------------|----------------|--------------|
| York County SWA      | \$55.6m  | 470,198       | \$3.6m         | \$185.9m     |
| Lancaster County SWA | \$104.7m | 941,470       | \$91.0m        | \$189.2m     |
| Chester County SWA   | \$22.6m  | 367,774       | \$0.0m         | \$ 92.5m     |
| Delaware County SWA  | \$48.0m  | 953,672       | \$5.7m         | \$9.8m       |



**DELAWARE COUNTY SOLID WASTE AUTHORITY  
JULY 2023  
TONNAGE SUMMARY**

|                          | MONTH         |               |               |            | YTD            |                |               |            |
|--------------------------|---------------|---------------|---------------|------------|----------------|----------------|---------------|------------|
|                          | Budget        | Actual        | Variance      | Variance % | Budget         | Actual         | Variance      | Variance % |
| Delaware County Refuse   |               |               |               |            |                |                |               |            |
| Delco Residential        | 13,982        | 14,430        | 448           | 3%         | 84,352         | 93,582         | 9,230         | 11%        |
| Delco Commercial         | 9,166         | 9,915         | 748           | 8%         | 66,756         | 70,842         | 4,086         | 6%         |
| Delco Direct Residential | 4,683         | 4,256         | (427)         | -9%        | 40,332         | 31,559         | (8,773)       | -22%       |
| Delco Direct Commercial  | 3,332         | 4,404         | 1,072         | 32%        | 30,018         | 29,525         | (493)         | -2%        |
| <b>Total Tons</b>        | <b>31,163</b> | <b>33,004</b> | <b>1,841</b>  | <b>6%</b>  | <b>221,457</b> | <b>225,507</b> | <b>4,050</b>  | <b>2%</b>  |
| Rolling Hills Landfill   |               |               |               |            |                |                |               |            |
| Covanta Ash              | 29,528        | 34,524        | 4,997         | 17%        | 218,505        | 227,095        | 8,590         | 4%         |
| Plymouth Ash             | 3,150         | 6,021         | 2,871         | 91%        | 23,307         | 24,483         | 1,176         | 5%         |
| Berks County             | 4,102         | 7,425         | 3,323         | 81%        | 30,357         | 48,200         | 17,843        | 59%        |
| Montgomery County        | 8,661         | 7,934         | (728)         | -8%        | 64,094         | 52,367         | (11,727)      | -18%       |
| Residual                 | 0             | 4,970         | 4,970         |            | 0              | 34,802         | 34,802        |            |
| <b>Total Tons</b>        | <b>45,441</b> | <b>60,874</b> | <b>15,433</b> | <b>34%</b> | <b>336,263</b> | <b>386,948</b> | <b>50,685</b> | <b>15%</b> |
| <b>System Tons</b>       | <b>76,604</b> | <b>93,878</b> | <b>17,274</b> | <b>23%</b> | <b>557,720</b> | <b>612,455</b> | <b>54,735</b> | <b>10%</b> |
| <b>Delco Tons to RHL</b> | <b>3,360</b>  | <b>3,578</b>  | <b>218</b>    | <b>6%</b>  | <b>23,520</b>  | <b>24,423</b>  | <b>903</b>    | <b>4%</b>  |

## ISSUE PAPER

**Issue:** Change Order- Placement of Protective Cover on Phase 1 at Rolling Hills Landfill

**Background:** The Phase 1 disposal cell was constructed with 4-acres of rain tarp and Wind Defender with no protective stone. This system allowed for greater slope stability and shedding of rainwater as storm water and not leachate. It has been the plan to remove the Wind Defender and place the required 18" of protective cover stone as Phase 1 gradually moved up the slope with waste being landfilled.

**Discussion:** Landfill management requested a proposal from Kinsley Construction Inc. (KCI) to remove the rain tarp with Wind Defender and place 18" of protective stone on 2.4 acres. KCI quoted price is \$155,700.00 to perform this work as they have the equipment and management already on site as part of their PAD 107 and Capping Contract. The work will be performed as a change order to the 107 Cell and 2023 Cap Construction project.

**Recommendation:** It is recommended the Board approve a change order in the amount of \$155,700 to KCI to place protective cover stone at part of the Phase 1 landfill cell.

Approved: \_\_\_\_\_

James McLaughlin, Chairman

August 16, 2023

# Installing Protective Cover Phase 1



**DELAWARE COUNTY SOLID WASTE AUTHORITY  
JULY 2023  
OPERATING BUDGET SUMMARY**

|                                    | Month              |                    |                  |            | YTD                                |                     |                     |                    |            |
|------------------------------------|--------------------|--------------------|------------------|------------|------------------------------------|---------------------|---------------------|--------------------|------------|
|                                    | Budget             | Monthly            | Variance         | Variance % | YTD Budget                         | YTD                 | Variance            | Variance %         |            |
| <b>REVENUE</b>                     |                    |                    |                  |            |                                    |                     |                     |                    |            |
| Delco Residential                  | \$1,106,587        | \$1,197,672        | \$91,085         | 8%         | Delco Residential                  | \$6,675,878         | \$7,771,451         | \$1,095,573        | 16%        |
| Delco Commercial                   | \$739,303          | 822,932            | 83,629           | 11%        | Delco Commercial                   | \$5,384,061         | \$5,885,849         | 501,788            | 9%         |
| Delco Direct Residential           | \$364,241          | 353,217            | (11,024)         | -3%        | Delco Direct Residential           | \$3,137,134         | \$2,566,513         | (570,621)          | -18%       |
| Delco Direct Commercial            | \$287,914          | 365,516            | 77,602           | 27%        | Delco Direct Commercial            | \$2,492,486         | \$2,425,467         | (67,019)           | -3%        |
| Covanta Ash                        | 651,673            | 737,640            | 85,967           | 13%        | Covanta Ash                        | \$4,822,382         | \$4,731,982         | (90,400)           | -2%        |
| Plymouth Ash                       | 68,882             | 135,954            | 67,072           | 97%        | Plymouth Ash                       | \$509,726           | \$542,657           | 32,931             | 6%         |
| Berks County                       | 214,184            | 415,939            | 201,755          | 94%        | Berks County                       | \$1,584,964         | \$2,671,704         | 1,086,740          | 69%        |
| Montgomery County                  | 518,126            | 463,972            | (54,154)         | -10%       | Montgomery County                  | \$3,834,132         | \$3,122,005         | (712,127)          | -19%       |
| Residual                           | 0                  | 234,309            | 234,309          |            | Residual                           | \$0                 | \$1,589,772         | 1,589,772          |            |
| Grants                             | 4,167              | 0                  | (4,167)          | -100%      | Grants                             | \$29,167            | \$174,106           | 144,940            | 497%       |
| Miscellaneous                      | 5,000              | 6,450              | 1,450            | 29%        | Miscellaneous                      | \$35,000            | \$262,288           | 227,288            | 649%       |
| <b>Total Revenue</b>               | <b>\$3,960,077</b> | <b>\$4,733,601</b> | <b>\$773,524</b> | <b>20%</b> | <b>Total Revenue</b>               | <b>\$28,504,930</b> | <b>\$31,743,795</b> | <b>\$3,238,865</b> | <b>11%</b> |
| Discounts                          |                    | 80,613             | 80,613           |            | Discounts                          |                     | \$562,862           | 562,862            |            |
| <b>Total Net Revenue</b>           | <b>\$3,960,077</b> | <b>\$4,652,988</b> | <b>\$692,910</b> | <b>17%</b> | <b>Total Net Revenue</b>           | <b>\$28,504,930</b> | <b>\$31,180,933</b> | <b>\$2,676,003</b> | <b>9%</b>  |
| <b>EXPENSES</b>                    |                    |                    |                  |            | <b>EXPENSES</b>                    |                     |                     |                    |            |
| Administration                     | \$232,149          | \$230,800          | (\$1,349)        | -1%        | Administration                     | \$1,678,236         | \$1,509,444         | (\$168,792)        | -10%       |
| Operations                         | 473,281            | 412,304            | (60,977)         | -13%       | Operations                         | \$3,370,581         | \$3,043,135         | (327,446)          | -10%       |
| Contract Hauling                   | 819,456            | 808,614            | (10,842)         | -1%        | Contract Hauling                   | \$5,349,201         | \$5,667,879         | 318,679            | 6%         |
| Covanta Processing                 | 1,260,647          | 1,360,965          | 100,318          | 8%         | Covanta Processing                 | \$8,974,597         | \$8,989,205         | 14,608             | 0%         |
| Delco Host Fees                    | 55,660             | 59,108             | 3,448            | 6%         | Delco Host Fees                    | \$396,247           | \$400,581           | 4,334              | 1%         |
| RHL Host Fees                      | 366,233            | 418,107            | 51,874           | 14%        | RHL Host Fees                      | \$2,694,990         | \$2,677,081         | (17,909)           | -1%        |
| HHW Events/Recycling               | 7,046              | 6,874              | (172)            | -2%        | HHW Events/Recycling               | \$49,321            | \$25,775            | (23,546)           | -48%       |
| <b>Total Expenses</b>              | <b>\$3,214,472</b> | <b>\$3,296,772</b> | <b>\$82,300</b>  | <b>3%</b>  | <b>Total Expenses</b>              | <b>\$22,513,173</b> | <b>\$22,313,101</b> | <b>(200,072)</b>   | <b>-1%</b> |
| <b>Debt P &amp; I Payments</b>     | <b>\$60,950</b>    | <b>\$60,950</b>    | <b>\$0</b>       |            |                                    | <b>\$426,650</b>    | <b>\$426,650</b>    | <b>\$0</b>         |            |
| <b>Operating Surplus (Deficit)</b> | <b>\$684,655</b>   | <b>\$1,295,266</b> | <b>\$610,610</b> | <b>89%</b> | <b>Operating Surplus (Deficit)</b> | <b>\$5,565,107</b>  | <b>\$8,441,182</b>  | <b>\$2,876,075</b> | <b>52%</b> |

**DELAWARE COUNTY SOLID WASTE AUTHORITY  
BUDGET PERFORMANCE SUMMARY**

|   | <b>July 2023</b> |                            |
|---|------------------|----------------------------|
| Capital Budget 2023   |                  | <b>\$6,280,000</b>         |
| Capital Expense YTD 2023                                    |                  | <b><u>\$3,139,615</u></b>  |
| Capital Budget Balance 2023                                 |                  | <b>\$3,140,385</b>         |
| <b>Summary</b>  |                  |                            |
| Net Operating Surplus July 2023                             |                  | <b>\$1,295,266</b>         |
| Capital Expense July 2023                                   |                  | <b>\$1,107,871</b>         |
| Capital Reserve Contribution                                |                  | <b>\$0</b>                 |
| Operating Account Contribution from Operating Surplus       |                  | <b>\$187,395</b>           |
| Capital Reserve Account Beginning Balance as of 07/01/23    |                  | <b>\$5,807,269</b>         |
| Capital Reserve Account Interest                            |                  | <b>\$26,023 (5.39%)</b>    |
| Capital Reserve Account Ending Balance as of 07/31/23       |                  | <b>\$5,833,292</b>         |
| Republic Operating Account Beginning Balance as of 07/01/23 |                  | <b>\$6,752,988</b>         |
| Republic Operating Account Interest                         |                  | <b>\$8,786 (1.56%)</b>     |
| Republic Operating Account Ending Balance as of 07/31/23    |                  | <b>\$4,888,733</b>         |
| PLGIT Short-Term Account Balance as of 07/31/23             |                  | <b>\$61,480 (5.17%)</b>    |
| Total Account Balances                                      |                  | <b><u>\$10,783,505</u></b> |
| <b>**Restricted Accounts**</b>                              |                  |                            |
| PLGIT Landfill Closure/PC Account Balance as of 07/31/23    |                  | <b>\$711,151 (5.39%)</b>   |

Delaware County Solid Waste Authority  
Accounts Payable Listing  
7/19/2023

|       |           |              |                                   |
|-------|-----------|--------------|-----------------------------------|
|       |           | \$116,362.76 | June Payroll                      |
| ACH   | 6/30/2023 | \$506.73     | AT&T Mobility                     |
| ACH   | 7/14/2023 | \$211.89     | AQUA Pennsylvania                 |
| ACH   | 7/12/2023 | \$453.57     | Comcast Business                  |
| ACH   | 7/11/2023 | \$872.43     | Kinetic Business (Windstream)     |
| ACH   | 6/28/2023 | \$3,718.19   | Met-Ed                            |
| ACH   | 7/14/2023 | \$784.91     | PECO Energy                       |
| ACH   | 7/5/2023  | \$75.27      | PECO Energy                       |
| ACH   | 6/26/2023 | \$914.90     | PenTela Data                      |
| ACH   | 7/7/2023  | \$6,236.77   | Republic Bank (VISA)              |
| ACH   | 6/26/2023 | \$200,000.00 | Wilmington Trust (Debt)           |
| ACH   | 6/26/2023 | \$11,522.86  | Wilmington Trust (Debt Interest)  |
| 61445 | 7/19/2023 | \$711.20     | A. N. Lynch Co., Inc.             |
| 61446 | 7/19/2023 | \$818.91     | Airgas USA, LLC                   |
| 61447 | 7/19/2023 | \$4,783.00   | American Rock Salt, Co. LLC       |
| 61448 | 7/19/2023 | \$244.84     | Aramark                           |
| 61449 | 7/19/2023 | \$3,512.50   | ARM Group LLC                     |
| 61450 | 7/19/2023 | \$281.29     | Associated Truck Parts            |
| 61451 | 7/19/2023 | \$337,476.72 | Berks County                      |
| 61452 | 7/19/2023 | \$3,295.90   | Blazosky Associates, Inc.         |
| 61453 | 7/19/2023 | \$40,906.06  | Borough of Pottstown              |
| 61454 | 7/19/2023 | \$730.97     | Chester Water Authority           |
| 61455 | 7/19/2023 | \$1,833.85   | Cintas First Aid & Supplies       |
| 61456 | 7/19/2023 | \$576.00     | Computer Center of North American |
| 61457 | 7/19/2023 | \$700,952.85 | Covanta Delaware Valley           |
| 61458 | 7/19/2023 | \$375.75     | Crystal Springs                   |
| 61459 | 7/19/2023 | \$977.00     | Dale's Fire Extinguishers         |
| 61460 | 7/19/2023 | \$7,657.32   | Delaware Co. Solid Waste Auth.    |
| 61461 | 7/19/2023 | \$601,433.51 | Earl Township Board of Supervisor |
| 61462 | 7/19/2023 | \$297,016.13 | Environmental Stewardship Fund    |
| 61463 | 7/19/2023 | \$108.43     | Federal Express Corporation       |

Delaware County Solid Waste Authority  
Accounts Payable Listing  
7/19/2023

|       |           |              |                                  |
|-------|-----------|--------------|----------------------------------|
| 61464 | 7/19/2023 | \$629.03     | Fraser Advanced Info. System     |
| 61465 | 7/19/2023 | \$814.50     | Fred Beans Ford of Boyertown     |
| 61467 | 7/19/2023 | \$648.24     | Gilbertsville Auto Supply        |
| 61469 | 7/19/2023 | \$6,041.31   | Foley, Inc.                      |
| 61470 | 7/19/2023 | \$393.59     | Xylem Dewatering Solutions, In   |
| 61471 | 7/19/2023 | \$91.09      | Groff Tractor & Equipment        |
| 61472 | 7/19/2023 | \$721.44     | Highmark Blue Shield             |
| 61473 | 7/19/2023 | \$87.86      | Hollenbach Home Center           |
| 61474 | 7/19/2023 | \$116.53     | Home Depot                       |
| 61475 | 7/19/2023 | \$5,112.33   | ICW Group                        |
| 61476 | 7/19/2023 | \$403.33     | Jani-King of Phila., Inc.        |
| 61477 | 7/19/2023 | \$1,822.50   | John J. McIntyre Sons, Inc.      |
| 61478 | 7/19/2023 | \$10,976.00  | Keystone Fire Protection Co.     |
| 61479 | 7/19/2023 | \$15.00      | Keystone SWANA                   |
| 61480 | 7/19/2023 | \$2,130.00   | Kinsley Construction Inc.        |
| 61481 | 7/19/2023 | \$1,400.00   | Lift, Inc.                       |
| 61482 | 7/19/2023 | \$13,729.82  | M-Core Electric, LLC             |
| 61483 | 7/19/2023 | \$1,919.90   | M. J. Reider Associates, Inc.    |
| 61484 | 7/19/2023 | \$37,691.79  | Martin Stone Quarries, Inc.      |
| 61485 | 7/19/2023 | \$496.50     | Wm. P. McGovern, Inc.            |
| 61486 | 7/19/2023 | \$5,019.45   | Wm. P. McGovern, Inc.            |
| 61487 | 7/19/2023 | \$670.00     | Ott's Lawn Service & Landscaping |
| 61488 | 7/19/2023 | \$114.46     | State Collection & Disbursements |
| 61489 | 7/19/2023 | \$124,052.35 | Commonwealth of PA               |
| 61490 | 7/19/2023 | \$125.00     | PA One Call System, Inc.         |
| 61491 | 7/19/2023 | \$204.19     | Petty Cash - RT                  |
| 61492 | 7/19/2023 | \$84.03      | Pitney Bowes Inc.                |
| 61493 | 7/19/2023 | \$477.06     | PMAA U.C. Fund                   |

Delaware County Solid Waste Authority  
Accounts Payable Listing  
7/19/2023

|              |           |                       |                                   |
|--------------|-----------|-----------------------|-----------------------------------|
| 61494        | 7/19/2023 | \$239.80              | Port A Bowl Restroom Co.          |
| 61495        | 7/19/2023 | \$50.00               | Pottstown Hospital                |
| 61496        | 7/19/2023 | \$32,934.08           | Practical Waste Solutions, LLC    |
| 61497        | 7/19/2023 | \$451.12              | Quigley Chevrolet                 |
| 61498        | 7/19/2023 | \$1,700.00            | R GOTWALS                         |
| 61499        | 7/19/2023 | \$31.00               | ReadyRefresh by Nestle            |
| 61500        | 7/19/2023 | \$1,750.00            | Riverview Landscaping, Inc.       |
| 61501        | 7/19/2023 | \$5,800.00            | Rudolph Clarke, LLC               |
| 61503        | 7/19/2023 | \$132.32              | Snap-On Tools                     |
| 61504        | 7/19/2023 | \$1,511.62            | Standard Insurance Co.            |
| 61506        | 7/19/2023 | \$13,890.50           | Suburban Testing Labs, Inc.       |
| 61507        | 7/19/2023 | \$4,235.00            | Susan M. Cordes                   |
| 61508        | 7/19/2023 | \$69,042.67           | PA Municipal Health Insurance     |
| 61509        | 7/19/2023 | \$720.00              | The Casindia Company, LLC         |
| 61511        | 7/19/2023 | \$1,280.47            | Tractor Supply Co.                |
| 61512        | 7/19/2023 | \$1,803.22            | United Concordia Co., Inc.        |
| 61513        | 7/19/2023 | \$500.00              | United States Postal Service      |
| 61514        | 7/19/2023 | \$8.76                | Verizon Telephone                 |
| 61515        | 7/19/2023 | \$270.00              | Victory Auto Glass                |
| 61516        | 7/19/2023 | \$102.86              | W. W. Grainger, Inc.              |
| 61517        | 7/19/2023 | \$25,710.76           | Waste Management                  |
| 61518        | 7/19/2023 | \$888,658.60          | Waste Management                  |
| 61519        | 7/19/2023 | \$385.00              | Whitetail Disposal                |
| 61520        | 7/19/2023 | \$20,394.29           | William R. Gift                   |
| 61521        | 7/19/2023 | \$60,122.99           | Wind River Environmental LLC      |
| 61522        | 7/19/2023 | \$1,794.58            | Winzer                            |
| 61523        | 7/19/2023 | \$4,481.44            | Wireback Works                    |
| 61524        | 7/19/2023 | \$2,269.91            | WM Corporate Services, Inc.       |
| 61525        | 7/19/2023 | \$843.75              | Z-Weldco, Inc.                    |
| 61526        | 7/19/2023 | \$453.88              | Earl Township Board of Supervisor |
| <b>TOTAL</b> |           | <b>\$3,702,908.43</b> |                                   |



Delaware County Solid Waste Authority  
Accounts Payable Listing  
7/19/2023

**CapEx**

|              |           |                     |                            |
|--------------|-----------|---------------------|----------------------------|
| 61466        | 7/19/2023 | \$7,166.56          | Geotechnics                |
| 61480        | 7/19/2023 | \$790,284.32        | Kinsley Construction Inc.  |
| 61502        | 7/19/2023 | \$15,472.00         | SITECH Metro Northeast LLC |
| 61505        | 7/19/2023 | \$7,795.00          | Stoney Creek Rentals, Inc. |
| 61510        | 7/19/2023 | \$52,483.00         | Tom Masano Ford            |
| <b>TOTAL</b> |           | <b>\$873,200.88</b> |                            |

# JULY

Delaware County Solid Waste Authority  
Invoices Selected for Payment

| Invoice Number     | V...  | Vendor Name                    | Invoice Description  | Invoice Amount |
|--------------------|-------|--------------------------------|--|----------------|
| 1050-100018...     | A...  | Abila                          | 8/2-9/1/23 MIP Cloud Conversion Subscription                 | 740.74         |
| 1050-100018...     | A...  | Abila                          | 8/2-9/1/2023 MIP HR & EWS Cloud                              | 294.40         |
| 1050-100018...     | A...  | Abila                          | MIP HR/EWS Setup & Training                                  | 2,812.50       |
|                    | To... | Abila                          |  | 3,847.64       |
| 9140403190         | Al... | Airgas USA, LLC                | Gray Elite (144)/Clear (72) Safety Glasses                   | 926.95         |
|                    | To... | Airgas USA, LLC                |  | 926.95         |
| 5330209664         | Ar... | Aramark                        | Employee Weekly Uniform Rentals (3) Transfer Stations        | 61.21          |
| 5330213039         | Ar... | Aramark                        | Employee Weekly Uniform Rentals (3) Transfer Stations        | 61.21          |
|                    | To... | Aramark                        |  | 122.42         |
| 0009805            | A...  | ARM Group LLC                  | Pad 107 & 2023 Capping Construction CQA (6/1-30/23)          | 33,710.03      |
| 0009759            | A...  | ARM Group LLC                  | RHLF 2023 Paving Project (6/1-30/23)                         | 3,057.25       |
| 0009690            | A...  | ARM Group LLC                  | Transfer Station Topo Surveys (6/1-30/23)                    | 1,768.25       |
| 0009769            | A...  | ARM Group LLC                  | Rolling Hills LF Ash Berm (6/1-30/23)                        | 7,734.50       |
| 0009694            | A...  | ARM Group LLC                  | DCSWA On-Call Engineering (6/1-30/23)                        | 17,314.25      |
|                    | To... | ARM Group LLC                  |  | 63,584.28      |
| 49                 | B...  | Blazosky Associates, Inc.      | Assistance with Quarterly Gas Monitoring                     | 471.30         |
|                    | To... | Blazosky Associates, Inc.      |  | 471.30         |
| 2019327            | C...  | C.S Products, Inc.             | 40 yd. 22ft.X8ft.X84in. Open Top Roll Off Container          | 8,929.00       |
|                    | To... | C.S Products, Inc.             |  | 8,929.00       |
| 4163312700         | Ci... | Cintas First Aid & Supplies    | Employee Weekly Uniform Rentals (15) & Coveralls (2)         | 463.00         |
| 5168431763         | Ci... | Cintas First Aid & Supplies    | Acct. #10511656 Misc. First Aid Supplies - RT                | 55.55          |
| 4161923478         | Ci... | Cintas First Aid & Supplies    | Employee Weekly Uniform Rentals (14) & Coveralls (2)         | 428.09         |
| 4162564525         | Ci... | Cintas First Aid & Supplies    | Employee Weekly Uniform Rentals (15) & Coveralls (2)         | 454.14         |
|                    | To... | Cintas First Aid & Supplies    |  | 1,400.78       |
| 110042             | C...  | Cotterino Supply & Equip. Co.  | Cut Edge(2),R/L End Bit(2),Plow Bolts,Nuts&Lockwasher-#4 D-6 | 1,615.54       |
| 110043             | C...  | Cotterino Supply & Equip. Co.  | Cut Edge(2),R/L End Bit,Plow Bolt(24) & Nut(24) JD 744K-II L | 2,498.08       |
| 110044             | C...  | Cotterino Supply & Equip. Co.  | Grease Cartridges #L0167-098 (4 cases @ 40/case)             | 1,521.32       |
|                    | To... | Cotterino Supply & Equip. Co.  |  | 5,634.94       |
| 0723_DCSWA         | C...  | Covanta Delaware Valley        | July, 2023 Waste Disposal                                    | 623,324.99     |
| 0723_DCSWA         | C...  | Covanta Delaware Valley        | July, 2023 Waste Disposal                                    | 59,108.14      |
|                    | To... | Covanta Delaware Valley        |  | 682,433.13     |
| 19888157<br>072223 | C...  | Crystal Springs                | Spring Water Supply & Mthly. Rental (Site/Office)            | 263.79         |
|                    | To... | Crystal Springs                |  | 263.79         |
| S102095862....     | D...  | Denney Electric Supply         | 1in. 90 Degree PVC Elbow & 1in. PVC Conduit (10ft.)          | 18.51          |
|                    | To... | Denney Electric Supply         |  | 18.51          |
| 26836              | E...  | EHD (Engle-Hambright & Davies) | 1 of 2 Annual Installments Broker of Record Pension Crime In | 796.00         |
|                    | To... | EHD (Engle-Hambright & Davies) |  | 796.00         |
| 8-209-86238        | F...  | Federal Express Corporation    | Fedex Envelope (2) LF & Fedex Envelope (RT)                  | 24.20          |

**Delaware County Solid Waste Authority**  
Invoices Selected for Payment

| Invoice Number | V...  | Vendor Name                    | Invoice Description  | Invoice Amount |
|----------------|-------|--------------------------------|--|----------------|
| 8-209-86238    | F...  | Federal Express Corporation    | Fedex Envelope (2) LF & Fedex Envelope (RT)                  | 63.17          |
| 8-202-64739    | F...  | Federal Express Corporation    | Fedex Envelope (2) LF & Fedex Envelope (RT)                  | 17.20          |
| 8-202-64739    | F...  | Federal Express Corporation    | Fedex Envelope (2) LF & Fedex Envelope (RT)                  | 73.98          |
|                | To... | Federal Express Corporation    |  | 178.55         |
| 02082141       | Fl... | Colliflower, Inc.              | Crimp Fitting 16N43-20-16 - #1 D-6T Dozer                    | 75.28          |
| 02082288       | Fl... | Colliflower, Inc.              | 1in. NPT Diesel Nozzle & Hose Assembly - #1 D-6T Dozer       | 520.90         |
|                | To... | Colliflower, Inc.              |  | 596.18         |
| INV1308099     | F...  | Fraser Advanced Info. System   | Contract CT5955-01 8/13-9/12/23 - Sharp MX3050V Copier/Scann | 180.00         |
|                | To... | Fraser Advanced Info. System   |  | 180.00         |
| 198673         | Gl... | Gilbertsville Auto Supply      | Bed Cover #92486 - PU#14 2023 F250 Truck                     | 475.00         |
| 200131         | Gl... | Gilbertsville Auto Supply      | NAPA Gold Fuel(7)/Oil(4)/Fuel&Water Separators Filters       | 416.61         |
| 200519         | Gl... | Gilbertsville Auto Supply      | CRC Wasp and Hornet Killer Spray #14010 (24)                 | 299.76         |
| 201359         | Gl... | Gilbertsville Auto Supply      | Dexron VI Transmission Fluid #92876 (12) less July discount  | 63.07          |
|                | To... | Gilbertsville Auto Supply      |  | 1,254.44       |
| INV0101651     | Gl... | Foley, Inc.                    | As-Fu(6)/Gp(3) Filters & As-X(2)/Filter(2) Elements-#1 730C2 | 675.99         |
| INV0105421     | Gl... | Foley, Inc.                    | Sensor Gp #3203061 & Coil AS #3848750 - CAT 826K Compactor   | 246.68         |
| INV0105331     | Gl... | Foley, Inc.                    | 24V Coil Assembly #2540072 - CAT 826K Compactor              | 35.31          |
| INV0105854     | Gl... | Foley, Inc.                    | Flange #1P4578 (4) #1 D-6T Dozer                             | 52.48          |
| INV0106687     | Gl... | Foley, Inc.                    | Seal #1P3704 (4) & Bolt/Washer/Nut (25 ea.) #1 D-6T Dozer    | 107.71         |
| INV0106755     | Gl... | Foley, Inc.                    | Hose Assembly #4500997 - #1 D-6T Dozer                       | 323.84         |
| INV0111750     | Gl... | Foley, Inc.                    | Primary/Acl Elements & Hydra/Element Filters - #1 D-6T Dozer | 350.33         |
| INV0101200     | Gl... | Foley, Inc.                    | Tread Plate #5359719 - #3 D-7 Cab Entry                      | 148.82         |
| INV0101087     | Gl... | Foley, Inc.                    | Plate #5359718 - #3 D-7 Cab Entry                            | 281.69         |
|                | To... | Foley, Inc.                    |  | 2,222.85       |
| 2307-128741    | H...  | Hollenbach Home Center         | 5/8in.X4ft.X8ft.Drywall,Joint Tape/Knives,Spackling&Screws-M | 80.99          |
|                | To... | Hollenbach Home Center         |  | 80.99          |
| 7159561        | J...  | J.K. Truck & Equipment         | PA State Inspection - 2006 F550 Dump Truck                   | 21.00          |
| 7159600        | J...  | J.K. Truck & Equipment         | PA State Inspection - 2022 Ford F150 Truck                   | 41.00          |
|                | To... | J.K. Truck & Equipment         |  | 62.00          |
| 176669         | JO... | John J. McIntyre Sons, Inc.    | 7/21/23 Perform Qtrly. Scale Calibration-Plt.#1              | 890.00         |
| 176709         | JO... | John J. McIntyre Sons, Inc.    | 7/26,27/23 Replace Girder Chair,Tronion/Bearing Blocks,Links | 5,375.48       |
|                | To... | John J. McIntyre Sons, Inc.    |  | 6,265.48       |
| 110            | K...  | Kathryn Sandoe LLC             | June, 2023 Consulting  | 300.00         |
|                | To... | Kathryn Sandoe LLC             |  | 300.00         |
| 2301460        | K...  | Keystone Engineering Group,Inc | 7/19/23 T/S Leachate Tank T-001/002 Level Signal Sensors     | 1,070.77       |
|                | To... | Keystone Engineering Group,Inc |  | 1,070.77       |
| 125229         | Ki... | Kinsley Construction Inc.      | Pad 107 & 2023 Cap Construction - Project No. 234030         | 761,010.35     |
|                | To... | Kinsley Construction Inc.      |  | 761,010.35     |
| 233601         | KI... | Kistler-O'Brien Fire Protectio | 5/4/23 Recharge Fire Suppression System - D6-20A #LKMT01045  | 3,246.36       |
|                | To... | Kistler-O'Brien Fire Protectio |  | 3,246.36       |

**Delaware County Solid Waste Authority**  
Invoices Selected for Payment

| Invoice Number  | V...  | Vendor Name                    | Invoice Description  | Invoice Amount |
|-----------------|-------|--------------------------------|--|----------------|
| 14632           | La... | Land Air Water Legal Solutions | Prof. Services 7/14/23 (2nd Qtr., 2023 CBP)                  | 346.50         |
|                 | To... | Land Air Water Legal Solutions |  | 346.50         |
| 25-00-03921-... | M...  | Marple Township Tax Collector  | Township of Marple 2023 School Real Estate Taxes             | 2,077.68       |
|                 | To... | Marple Township Tax Collector  |  | 2,077.68       |
| P-154381        | M...  | Wm. P. McGovern, Inc.          | 7/26-8/22/23 Portable Restroom Rental(2) Plt.#1              | 231.00         |
| P-154380        | M...  | Wm. P. McGovern, Inc.          | 7/26-8/22/23 Portable Restroom Rental-Plt.#3                 | 115.50         |
|                 | To... | Wm. P. McGovern, Inc.          |  | 346.50         |
| S-2225489       | M...  | Wm. P. McGovern, Inc.          | Pump Out Disposal Tank (3343 gals.) Plt.#1                   | 354.25         |
| S-2225490       | M...  | Wm. P. McGovern, Inc.          | Pump Out Disposal Tanks (8000 gals.) Plt.#3                  | 1,035.50       |
| S-2227063       | M...  | Wm. P. McGovern, Inc.          | Pump Out Disposal Tank (3057 gals.) Plt.#3                   | 397.85         |
| S-2227313       | M...  | Wm. P. McGovern, Inc.          | Pump Out Disposal Tanks (1200 & 1558 gals.) Plt.#1           | 490.50         |
| S-2227314       | M...  | Wm. P. McGovern, Inc.          | Pump Out Disposal Tank (1227 gals.) Plt.#3                   | 289.07         |
|                 | To... | Wm. P. McGovern, Inc.          |  | 2,567.17       |
| 304028-7        | M...  | Moyer Indoor/Outdoor           | 7/23 Pest Control Service - Plt.#3                           | 312.64         |
| 300132-6        | M...  | Moyer Indoor/Outdoor           | 6/23 Pest Control Service - LF                               | 289.50         |
| 300132-7        | M...  | Moyer Indoor/Outdoor           | 7/23 Pest Control Service - LF                               | 289.50         |
|                 | To... | Moyer Indoor/Outdoor           |  | 891.64         |
| 119241          | M...  | MXI Environmental Services LLC | 6/3/2023 Household Hazardous Waste Collection                | 48,826.70      |
|                 | To... | MXI Environmental Services LLC |  | 48,826.70      |
| 1266            | Ot... | Ott's Lawn Service & Landscapi | Lawn Service (7/4,10,17,24,31/23)                            | 1,675.00       |
| 1258            | Ot... | Ott's Lawn Service & Landscapi | 7/14/23 Labor/Mtrls. Landscaping Around New Sign             | 1,035.00       |
|                 | To... | Ott's Lawn Service & Landscapi |  | 2,710.00       |
| 1299380         | P...  | PA DEP-Tank                    | Gas#600935,HZSUB#925881/1136606/1157871 Tank Fees (6/23-6/24 | 200.00         |
|                 | To... | PA DEP-Tank                    |  | 200.00         |
| 51270877        | Pe... | PetroChoice LLC                | Diesel Exhaust Fluid (DEF) 2.5 gals.@80 cases/pallet(2)      | 1,803.20       |
|                 | To... | PetroChoice LLC                |  | 1,803.20       |
| ESA024494       | Pl... | Plasterer Equipment Co., Inc.  | 2023 John Deere 750L Crawler Dozer S/N 1T0750LXTPF447987     | 256,900.00     |
|                 | To... | Plasterer Equipment Co., Inc.  |  | 256,900.00     |
| INV/2023/18...  | Po... | Port A Bowl Restroom Co.       | Portable Toilets (2 Units) 7/24-8/20/23 & Hand Sanitizer     | 228.80         |
|                 | To... | Port A Bowl Restroom Co.       |  | 228.80         |
| 020             | Pr... | Practical Waste Solutions, LLC | CEO Consulting Services (7/1-31/23) J. Warner                | 27,957.36      |
|                 | To... | Practical Waste Solutions, LLC |  | 27,957.36      |
| 119821          | Q...  | Quigley Chevrolet              | Pipe #85584364 (Transmission Line) PU#11 2020 2500 Silverado | 56.67          |
|                 | To... | Quigley Chevrolet              |  | 56.67          |
| 001A            | S...  | S.J. Thomas Company, Inc.      | Locker & Bathroom Interior Remodel @ Maintenance Building    | 25,695.39      |
|                 | To... | S.J. Thomas Company, Inc.      |  | 25,695.39      |

**Delaware County Solid Waste Authority**  
Invoices Selected for Payment

| Invoice Number | V...  | Vendor Name                  | Invoice Description  | Invoice Amount |
|----------------|-------|------------------------------|--|----------------|
| 0473353        | S...  | SCS Engineers                | 2nd Qtr., 2023 Surface Monitoring Emissions                  | 4,060.00       |
| 0471529        | S...  | SCS Engineers                | Leachate Evaporation Evaluation (6/1-6/30/23)                | 9,066.00       |
|                | To... | SCS Engineers                |  | 13,126.00      |
| 189883         | St... | Stoney Creek Rentals, Inc.   | Gas Spring #05581241 (2) Bomag Roller Hood Struts            | 194.25         |
|                | To... | Stoney Creek Rentals, Inc.   |  | 194.25         |
| P3001894       | S...  | Suburban Testing Labs, Inc.  | Outfall 006,Weekly Outfall 007/T-002 & Monthly SP-5/6        | 2,341.00       |
| P3001894A      | S...  | Suburban Testing Labs, Inc.  | Quarterly Sump P1  | 408.50         |
|                | To... | Suburban Testing Labs, Inc.  |  | 2,749.50       |
| 080123         | S...  | Susan M. Cordes              | 7/1-31/23 Recycling Consultant (70.5 hrs.)                   | 3,877.50       |
|                | To... | Susan M. Cordes              |  | 3,877.50       |
| 2024-82400     | S...  | SWANA                        | Annual Membership - D. Moser                                 | 285.00         |
|                | To... | SWANA                        |  | 285.00         |
| 8795           | Th... | The Casindia Company, LLC    | 7/23 Cleaning Service (Admin. Bldg. & Scalehouse@LF)         | 720.00         |
| 8817           | Th... | The Casindia Company, LLC    | Interior & Exterior Window Cleaning - June, 2023             | 290.00         |
|                | To... | The Casindia Company, LLC    |  | 1,010.00       |
| 24522          | TSI   | The Standard Group           | Destination Forms (1,000)                                    | 300.87         |
| 24426          | TSI   | The Standard Group           | Residual Waste Non-Hazardous Manifest (1,000)                | 533.41         |
|                | To... | The Standard Group           |  | 834.28         |
| 9781174777     | W...  | W. W. Grainger, Inc.         | Wall Mounting Key Locking Mailbox #465D75                    | 77.89          |
| 9767618649     | W...  | W. W. Grainger, Inc.         | Various Safety Signs(9),28in.Traffic Cones(12)&Rain Jacket(M | 273.04         |
| 9769949158     | W...  | W. W. Grainger, Inc.         | 7X10in. Plastic Notice Sign #44UH70                          | 6.73           |
| 9772536323     | W...  | W. W. Grainger, Inc.         | 14X10in. Vinyl Safety Sign #475J12 (2)                       | 9.72           |
| 9774215371     | W...  | W. W. Grainger, Inc.         | 10in. Steel Garden Hose Reel #2LRL2                          | 185.82         |
| 9781743803     | W...  | W. W. Grainger, Inc.         | 16in.Guard Mounted Exhaust Fan&Yellow Traffic Paint(1 gal.)  | 271.11         |
|                | To... | W. W. Grainger, Inc.         |  | 824.31         |
| July2023       | W...  | Waste Management             | July, 2023 Contract Hauling-Plt.#1                           | 363,357.08     |
| July2023RH     | W...  | Waste Management             | July, 2023 Rolling Hills Landfill-Plt.#1                     | 22,443.41      |
| July23         | W...  | Waste Management             | July, 2023 Contract Hauling-Plt.#3                           | 279,292.27     |
| July23RH       | W...  | Waste Management             | July, 2023 Rolling Hills Landfill-Plt.#3                     | 143,521.56     |
|                | To... | Waste Management             |  | 808,614.32     |
| 12739          | W...  | William R. Gift              | Off Road Diesel Fuel (1720.3 gals.)                          | 5,160.90       |
| 10221          | W...  | William R. Gift              | Off Road Diesel Fuel (1665 gals.)                            | 4,645.35       |
| 12731          | W...  | William R. Gift              | Unleaded Gasoline (414 gals.)                                | 1,121.94       |
|                | To... | William R. Gift              |  | 10,928.19      |
| 5943117        | W...  | Wind River Environmental LLC | Leachate Hauling 7/1-15/23 (1,210,113 gals.)                 | 56,391.48      |
|                | To... | Wind River Environmental LLC |  | 56,391.48      |
| 1228           | W...  | Wireback Works               | 7/1-7/31/23 HR Consulting Services                           | 5,241.24       |
|                | To... | Wireback Works               |  | 5,241.24       |
| 2624396-254... | W...  | WM Corporate Services, Inc.  | 8/1-8/31/23 Dumpster Service (2 yds.) Recycling              | 124.71         |

**Delaware County Solid Waste Authority**  
Invoices Selected for Payment

| Invoice Number | V...  | Vendor Name                 | Invoice Description  | Invoice Amount             |
|----------------|-------|-----------------------------|--|----------------------------|
| 2619090-254... | W...  | WM Corporate Services, Inc. | 7/1-7/31/23 Recycling Dumpsters 2(12)/4(4)/96(3) yds. Servic | 2,557.17                   |
| 2624216-254... | W...  | WM Corporate Services, Inc. | 8/1-8/31/23 Dumpster Service (4 yds.) Recycling              | 218.33                     |
|                | To... | WM Corporate Services, Inc. |  | <u>2,900.21</u>            |
| Report Total   |       |                             |  | <u><u>2,822,480.60</u></u> |

## **ISSUE PAPER**

**Issue:** Selecting NextEra Energy for LFG Project Development

**Background:** The RHL generates methane gas and uses a flare to “destroy” the methane gas. Capturing methane gas and using it to generate renewable energy is an upgrade in environmental management and creates value to the owner of the methane gas. In April, the Authority, with assistance from our consultant, SCS Services, issued an RFP for companies to propose to develop, finance, permit, own and operate an LFG energy recovery system. In early June, four companies submitted proposals and two companies, North American Power (NAP) (Ann Arbor, MI) and NextEra Energy (Juno Beach, FL) were selected for additional negotiation. Both companies proposed the installation of internal combustion engines to process the methane to create renewable electricity and sell it to the grid.

**Discussion:** Since mid-June, the Authority and SCS services have been clarifying information and negotiating terms and conditions with both NAP and NextEra. Each proposer is well qualified and has a successful history of doing similar projects. NextEra was chosen for the following reasons:

1. NextEra has a successful history in PA including permitting five projects in the same DEP Southcentral region as RHL and two in the same Met-Ed interconnection district as RHL. NAP has no history in PA.
2. NextEra is very well capitalized and is a Fortune 200 company. NAP is a family-owned business.
3. NextEra development team is based in Allentown, PA and they have decades of experience. NAP is based in Michigan.
4. NextEra will share 15 to 20% of all project revenue, including both market price and energy production pathways to 20% sharing. NAP proposed 25% but their partnerships were vague and uncertain as parts were based on foreign third-party purchase commitments with limited duration. NextEra has the most sophisticated REC trading desk in the US.
5. NextEra plans to scrub sulfur dioxide from the gas before combustion, NAP did not, so emissions will be cleaner with NextEra.
6. NAP’s proposal was contingent on piping supplemental NG to the power plant from a private distribution line not required to provide access to their NG adding overall uncertainty to their ability to perform.

**Recommendation:** The Board approves selecting NextEra Energy for exclusive negotiations to enter into a 20-year agreement for exclusive rights to the methane generated at the Rolling Hills Landfill.

**Approved:** \_\_\_\_\_

James McLaughlin, Chairman

Date: August 16<sup>th</sup>, 2023



## Delaware County Solid Waste Authority

Rose Tree Park ~ Hunt Club  
1521 N. Providence Road  
Media, PA 19063-1039  
610-892-9620 [www.delcoswa.org](http://www.delcoswa.org)

Board of Directors  
James McLaughlin  
Chairman  
William Silverstein  
Vice Chairman  
Robert Layden  
John Butler  
James P. Kelly  
William Jones  
Steven Goldfield  
Christine Reuther, Ex-Officio  
Don Vymazal, Ex-Officio  
  
Michael Clarke, Solicitor  
James D. Warner  
Interim CEO

August 16, 2023

Mr. Steve Gabrielle

NextEra Renewable Fuels, LLC

1605 N Cedar Crest Blvd, Suite 509

Allentown, PA 18104

RE: RFP Selection to Negotiate

Dear Steve:

We are pleased to notify you of DCSWA's selection of NextEra Renewable Fuels, LLC to develop a landfill gas to energy project at the Rolling Hills Landfill. This selection is based on our evaluation of all proposals received and the initial proposal from NextEra and follow-up information provided in negotiations.

We ask that NextEra provide its form of Landfill Gas Purchase and Lease agreements with specific terms from your proposal. DCSWA agrees to enter exclusive negotiations with NextEra until December 31, 2023, unless extended, in order to enter into definitive agreements.

We understand NextEra will begin preliminary permitting, engineering, and other development work during this period which we will support.

DCSWA looks forward to bringing this project to fruition.

Sincerely,

James McLaughlin, Board Chairman

Cc: Brooks Stayer, CEO

Jim Warner, Consultant



## ISSUE PAPER

**Issue:** Selecting SCS Engineers as Transfer Station Consulting Firm

**Background:** In May, the Authority issued an RFP for the purpose of hiring a consulting firm to coordinate the design, engineering, permitting, bid document preparation and process coordination and construction administration for two new transfer stations and other related infrastructure in Delaware County. The Authority received three (3) responses which included:

1. HDR and ARM Group
2. SCS Engineers and D&B
3. Civil and Environmental Engineers (CEC) Inc.

All three of these firms along with their proposed project partners, are qualified to do the proposed work. As part of the evaluation process, price was to comprise 20% of the proposal scoring. However, because the price from the HDR/ARM proposal was more than twice the other two, they were eliminated from further evaluation. Proposal pricing after seeking clarifications from the three firms was as follows:

- HDR and ARM: \$2,400,000 (did not include Task 11: Contract Administration)
- SCS Engineers: \$922,000 (includes 8% admin fee and is a Time & Material est.)
- CEC, Inc: \$924,000 (includes 11% admin fee and is a Time and Material est.)

**Discussion:** Both SCS and CEC have provided satisfactory consulting to DCSWA in the past. Project pricing from both firms is virtually the same, so transfer station project experience and stated understanding of this complicated project was of the utmost importance. Both firms and their teams have good experience with multiple public and private transfer stations. SCS better stated the complete understanding of the job and its complexities. Both score high in the points evaluations with SCS having 93 points and CEC 86 points.

**Recommendation:** The Board approves selecting SCS Engineers as its consultant to build two new transfer stations and renovate both transfer station properties including select demolition at both locations.

**Approved:** \_\_\_\_\_

James McLaughlin, Chairman

Date: August 17<sup>th</sup>, 2023

## Transfer Station Consultant Response Evaluation Summary

Three proposals were received. The firms that submitted were:

1. SCS Engineers
2. Civil and Environmental Consultants, Inc (CEC)
3. HDR/ARM Group

The RFP listed evaluation criteria with weighted scoring as follows:

### EVALUATION CRITERIA

Proposals will be evaluated initially according to the following:

1. Organization - pertinent knowledge and experience of the personnel which will be assigned to the Project. **(20 points)**
2. The relevant experience and demonstrated ability of the firm with refuse storage, processing facilities, and transfer station projects. **(20 points)**
3. An intimate knowledge of the regulatory agencies and their permitting processes; with particular emphasis on experience with obtaining permits and addressing the concerns of stakeholders. **(25 points)**
4. The direct and demonstrated knowledge of the project history. (10 points)
5. Cost Proposal. **(20 points)**
6. Sustainability Innovation – experience with designing LEED certified facilities or sites with sustainability features addressing energy, water, waste, EVs, etc. **(5 points)**

### SELECTION PROCESS

The Authority may designate a committee to review proposals, conduct interviews, and recommend the award of a contract. The Authority intends to select one qualified firm to provide the services requested and sign a contract with that firm. The Authority reserves the right in its sole discretion to reject any, or all, proposals, or to re-publish this Request for Proposals, and may determine to contract outside of a request for proposals process. This Request for Proposals is not subject to the competitive bidding process, and any contract entered into as a result of any response submitted will not be based on the concept of the ‘lowest responsible bidder’.

## SCORING SUMMARY

### Proposer: SCS Engineers

- 1.) Organization - pertinent knowledge and experience of the personnel which will be assigned to the Project. **(20 points)**

The direct experience with transfer station development appears diverse, especially with adding D&B's experience. Lead engineer has several larger projects with significant lead role. **(18 points)**

2. The relevant experience and demonstrated ability of the firm with refuse storage, processing facilities, and transfer station projects. **(20 points)**

SCS has a multitude of experiences in all types of waste management facilities. They have done numerous public waste and recycling drop-offs. Their sub-contractor D&B has a strong history in the Northeast. **(15 points)**

3. An intimate knowledge of the regulatory agencies and their permitting processes; with particular emphasis on experience with obtaining permits and addressing the concerns of stakeholders. **(25 points)**

SCS has proposed a lead team that is based in Pennsylvania (Denver, PA) and has deep experience with DEP officials. They have a strong history on working on public projects where there is a variety of stakeholders. **(25 points)**

4. The direct and demonstrated knowledge of the project history. **(10 points)**

Very high understanding, well-articulated. **(10 points)**

5. Cost Proposal. **(20 points)**

SCS has proposed the lowest cost at \$902,800 **(20 points)**

6. Sustainability Innovation – experience with designing LEED certified facilities or sites with sustainability features addressing energy, water, waste, EVs, etc. **(5 points)**

SCS emphasized they will make an effort to incorporate LEED features where appropriate and have a LEED professional on their team. **(5 points)**

**TOTAL POINTS : 93**

## SCORING SUMMARY

### Proposer: Civil and Environmental Consultants (CEC)

1. Organization - pertinent knowledge and experience of the personnel which will be assigned to the Project. **(20 points)**  
Direct experience strong with lots of transfer station projects in New Jersey market over past 15 years.  
**(18 points)**
2. The relevant experience and demonstrated ability of the firm with refuse storage, processing facilities, and transfer station projects. **(20 points)**  
Significant experience in a variety of waste management facilities, including over 50 transfer stations. **(20 points)**
3. An intimate knowledge of the regulatory agencies and their permitting processes; with particular emphasis on experience with obtaining permits and addressing the concerns of stakeholders. **(25 points)**  
Lots of permit experience including obtaining major and minor permits in all six PA DEP regions. Chosen by major waste haulers to do project. **(20 points)**
4. The direct and demonstrated knowledge of the project history. **(10 points)**  
Very good detail about the work needed to successfully complete the projects. Failed to mention and cost in the HHW Facility per description. **(8 points)**
5. Cost Proposal **(20 points)**  
CEC had the second lowest costs but in-line with SCS **(20 points)**
6. Sustainability Innovation – experience with designing LEED certified facilities or sites with sustainability features addressing energy, water, waste, EVs, etc. **(5 points)**  
**(0 points)** CEC did not mention any LEED initiatives

**TOTAL POINTS: 86**

## ISSUE PAPER

**Issue:** Purchase of Furniture for New Office

**Background:** The Authority has entered into a 5-year office lease for space located at 610 E. Baltimore Pike, Media, Pa (actually located in Nether Providence Twp). The office does not come furnished with office furniture. The Authority staff need office furniture to carry out their duties. The Authority does not own the furniture it uses in its current location which is owned by Delaware County government.

**Discussion:** The Authority researched furniture suppliers under the COSTARS purchasing program in order to save time and money. The Authority engaged Office Basics, with a location in Boothwyn, PA to assist in outfitting the new office space with the appropriate office components which includes desks, chairs, workstations, tables, guest chairs and more. Office Basics has provided the Authority with a n itemized listing of costs (including a variety of discounts) with the final amount due for the order being \$62,290.63

**Recommendation:** The Board approves ordering furniture from Office Basics, Inc in the amount of \$62,290.63

**Approved:** \_\_\_\_\_

James McLaughlin, Chairman

Date: August 16<sup>th</sup>, 2023

**FURNITURE AGREEMENT FOR OB PA COSTARS 035-E22-174 CONTRACT**

**HON Discounting as follows:**

Systems Furniture and Related items  
48% (Installed \$100.00 to \$9,999.00)  
50.6% (Installed \$10,000.00 to \$49,999.00)  
53.3 % (Installed \$50,000 to \$99,999.00)  
**Negotiated Tiered Discounting after \$100,000.00**

Veneer & Laminate Casegoods  
48% (Installed \$100.00 to \$9,999.00)  
48% (Installed \$10,000.00 to \$49,999.00)  
49.3 % (Installed \$50,000 to \$99,999.00)  
**Negotiated Tiered Discounting after \$100,000.00**

All other HON products- excluding Basyx and Sooth high back patient chair and recliner  
48% (Installed \$100.00 to \$9,999.00)  
49.3% (Installed \$10,000.00 to \$49,999.00)  
51.3 % (Installed \$50,000 to \$99,999.00)  
**Negotiated Tiered Discounting after \$100,000.00**

**Safeco/Mayline Discounting as follows:**

45% (Off curent list price)

**Buyer Authorized Initials (Accepting Terms and Conditions):** \_\_\_\_\_

**\* ALL CHECKS AND PURCHASE ORDERS SHOULD BE MADE PAYABLE TO:**

Office Basics, Inc.  
Costars #035-E22-174  
22 Creek Circle  
P.O. Box 2230  
Boothwyn, PA 19061

| Qty.                | Product | Description             | Discount | Sell                  | Ext. Sell          |
|---------------------|---------|-------------------------|----------|-----------------------|--------------------|
| 5                   | HWSB2   | Worksurface Bracket Kit | 53.30    | \$ 28.95              | \$144.75           |
|                     |         | \$(P1) P1 Paint Opts    |          |                       |                    |
|                     |         | .LOFT Loft              |          |                       |                    |
|                     |         |                         |          | <b>Subtotal:</b>      | <b>\$13,063.91</b> |
| <b>Installation</b> |         |                         |          | \$ 7,773.33           | \$7,773.33         |
|                     |         |                         |          | <b>Project Total:</b> | <b>\$62,290.63</b> |

1 | FURNITURE PLAN

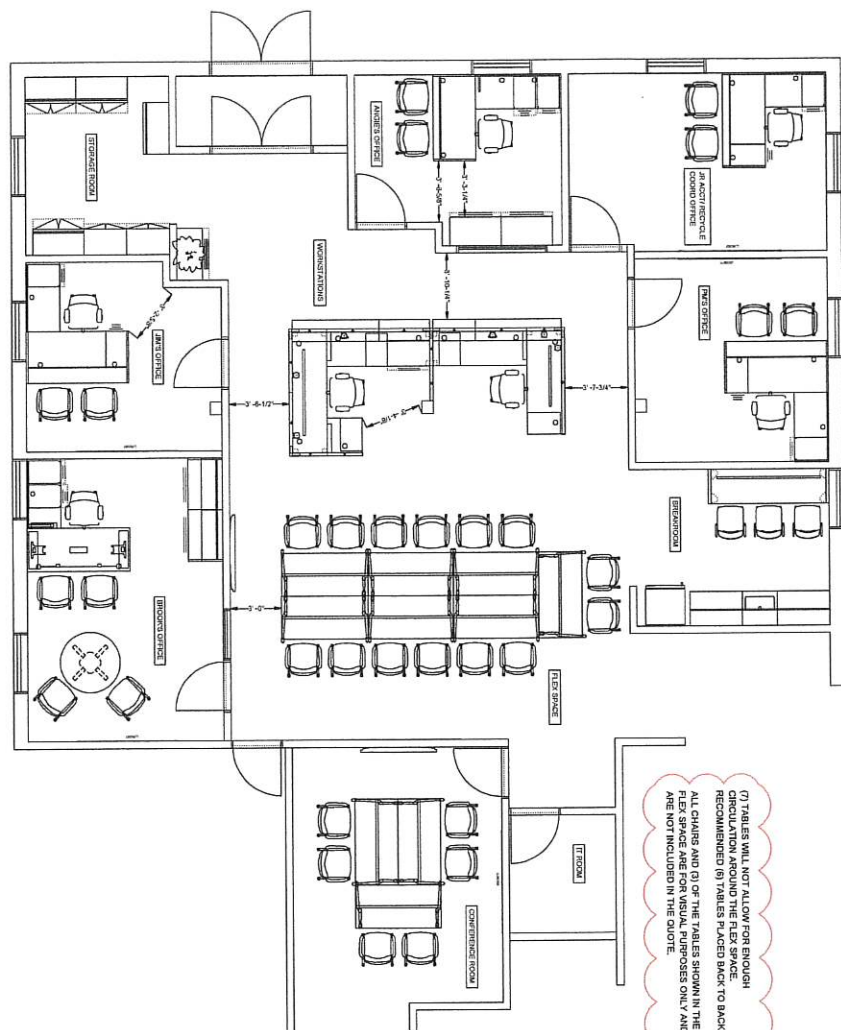

|                                |   |                                       |   |
|--------------------------------|---|---------------------------------------|---|
| DRAWN BY: RGL<br>REVISIONS: 00 | DCSWA<br><br>610 EAST BALTIMORE PIKE<br>MEDIA, PA 19063 | FURNITURE PLAN<br><br>DATE: 8/11/2023 | <small>OFFICE BASICS INC. EXPRESSLY DISCLAIMS ANY AND ALL WARRANTIES, INCLUDING BUT NOT LIMITED TO, IMPLIED WARRANTIES OF MERCHANTABILITY AND FITNESS FOR A PARTICULAR PURPOSE. ALL CONTENTS, SPECIFICATIONS AND COPIES THEREOF ARE AND SHALL REMAIN THE PROPERTY OF OFFICE BASICS INC. THEY ARE TO BE USED ONLY IN CONNECTION WITH THE PROJECT AND ARE NOT TO BE USED IN ANY OTHER PROJECT. YOU ARE HEREBY ADVISED TO NOTIFY US IMMEDIATELY WITHOUT DELAY IF YOU ARE NOT SATISFIED WITH THE RESULTS OF OUR WORK. WRITTEN PERMISSION AND CONSENT FROM OFFICE BASICS INC. IS REQUIRED.</small> |
| SCALE: XX" = 1'-0"             |   |                                       |   |



1 | FURNITURE PLAN - BIRDS EYE VIEW RENDERING



22 CREEK CIRCLE, BOOTHMAN PA 19061  
(P) 800-641-8855 (F) 866-226-4048

DRAWN BY: RGL  
REVISIONS: 00

SCALE: XX" = 1'-0"

DCSWA

610 EAST BALTIMORE PIKE  
MEDIA, PA 19063

FURNITURE PLAN

BIRDS EYE VIEW RENDERING

DATE:

8/11/2023

OFFICE BASICS, INC. EXPRESSLY  
RESERVED ITS COMMON LAW  
COPYRIGHT AND OTHER PROPERTY  
RIGHTS IN THESE DOCUMENTS. ALL  
DRAWINGS, SPECIFICATIONS AND  
NOTES THEREOF ARE AND SHALL  
REMAIN THE PROPERTY OF OFFICE  
BASICS, INC. THEY ARE TO BE USED  
ONLY WITH RESPECT TO THIS  
PROJECT AND ARE NOT TO BE USED  
ON ANY OTHER PROJECT. NO USE  
THEREOF IS TO BE ASSIGNED TO ANY THIRD  
PARTY WITHOUT FIRST OBTAINING  
WRITTEN PERMISSION AND CONSENT  
FROM OFFICE BASICS, INC.

**REQUEST FOR PROPOSALS (RFP)**

**DCSWA NEW TRANSFER  
STATION LAND  
DEVELOPMENT  
CONSULTING  
ENGINEERING SERVICES**

**August, 2023**

Proposal Submittal: Proposals must be submitted via **PennBid** to Delaware County Solid Waste Authority.

**ALL PROPOSALS MUST BE RECEIVED BEFORE 4:00, FRIDAY, SEPTEMBER 8<sup>TH</sup>, 2023. LATE PROPOSALS WILL NOT BE ACCEPTED.**

Any requests for clarification or other questions concerning this RFQ must be submitted via **PennBid** before 4:00 PM on Friday, August 25th, 2023.

**DCSWA reserves the right to reject any or all proposals, to waive any component in any proposal, and to select the proposal that best meets the Authority's needs.**

**1. BACKGROUND/INTRODUCTION**

DCSWA is a PA Municipal Authority which operates under a 7-member Board of Directors appointed by the Delaware County Council to 5-year staggered terms. The Authority is seeking qualifications and proposals from qualified engineering firms ("Consultant") to provide project related local land development services.

**2. PURPOSE**

The purpose of this Request for Proposal ("RFP") is to solicit competitive proposals from qualified firms to provide specific local municipal and county land development project services.

**3. THE PROJECTS**

The Authority owns two transfer stations located in Delaware County, PA. Transfer Station #1 is located at 2300 Concord Rd. Chester, PA. 19013 (Chester Township). Transfer Station #3 is located at 895 Sussex Blvd, in Broomall, PA 19008 (Marple Township). Both transfer stations are operated under a long-term contract with Waste Management (WM) and having surpassed their useful lives and need to be replaced. Both locations will be redeveloped with new buildings, new traffic patterns, significant regrading and substantial demolition.

#### **4. SCOPE OF SERVICES**

The Authority seeks a consulting engineering firm that is experienced and equipped to provide the following services in conjunction with the transfer station projects:

- Erosion and Sedimentation design and permitting
- Sewage Approvals
- Zoning Variences
- Stormwater Management design and permitting
- Any other permit and/or approvals required by Marple Township, Chester Township, and the County of Delaware

The Consultant will be expected to work closely with the Authority's engineering firm who is overseeing both projects in Marple Township and Chester Township.

The Consultant should have prior experience doing similar work in Delaware County and be familiar with the land development process in both Marple Township and Chester Township.

#### **5. ADDENDA**

Any subsequent changes in the RFP from the date of preparation to date of submittal will result in an addendum by the Authority.

#### **6. SUBMITTAL INFORMATION AND DEADLINE**

Written proposals in accordance with the specifications and directions provided herein must be received **no later than 4:00 p.m. Friday, September 8th, 2023**. Proposals must be sealed and clearly marked "Proposal for Transfer Station Land Development Consulting Services" on the exterior of the envelope and addressed to: James D. Warner, Delaware County Solid Waste Authority 610 E. Baltimore Avenue, Media, Pa 19063 (fyi, this is a new office location)

#### **7. SUBMITTAL REQUIREMENTS**

Respondents desiring to respond to the RFP shall submit an original and two (2) copies of the proposal, marked on the outside "Proposal for Transfer Station Land Development Consulting Services RFP." Service fees and hourly rates shall be submitted with the proposal. All submission materials shall also be provided electronically, via thumb drive. The proposals shall include the name of the respondent.

If sent via USPS Mail or UPS/FEDEX:

James D. Warner

Delaware County Solid Waste Authority

610 E. Baltimore Avenue

Media, Pa 19063

Responses sent by telephone or email will not be accepted. It is the sole responsibility of each proposer to ensure that its proposal reaches the Authority by the time and date specified. Once opened, all responses become the public record and will be available to the public for review.

## **8. INFORMATION TO BE SUBMITTED**

The following information should be included in the submitted RFP.

- A. Letter of Introduction** – Briefly describe the firm, including its history and number and location of offices; the name, address, email and phone number of the contact person as well as a summary of the respondent's understanding of the scope of services and overall approach to providing those services. The letter should be signed by an officer or principal of the respondent's firm authorized to bind the firm of all commitments made in the proposal.
- B. Experience and Qualifications** – Describe any and all relevant experience and qualifications including specific certifications and licensures of the primary consulting engineer that would be assigned to the Projects, as well as all key individuals that may be involved in providing the services specified in the Scope of Services. Provide resumes for all key personnel. Include list of projects with land development services the firm has participated in during the past five (2) years within Engineer must be registered as a professional engineer by the Pennsylvania State Board of Professional Engineers. He/She must have a B.S. degree with work in engineering and five years of public work and/or municipal engineering experience.
- C. References** – Provide at least three (3) references that may be contacted for verification of the respondent's experience and qualifications with municipalities in Pennsylvania; preferably first-class townships in the Greater Philadelphia Region.
- D. Rate and Service Structure** – Provide the comprehensive fee schedule for personnel and services.
- E. Legal** – Describe any lawsuits filed against the firm during the past five (2) years.
- F. Insurance Requirements** – All required insurance must be current and up to date in advance and renewed annually.

## **9. CONSULTANT SELECTION**

The Authority will review the responses to the RFP and decide as to the most responsive, best suited, and most qualified to provide the services requested. A limited number of candidates may be selected for interviews by the Authority.

Generally, the selection criteria will include, but is not limited to:

- The responsiveness to the specific understanding of the services to be provided for the Projects.
- Experience, expertise and knowledge particular to providing land development permitting
- Cost of professional services

#### **10. METHOD OF PAYMENT**

The selected Consultant shall submit monthly invoices, separated by project, to the Authority for the services rendered in that month. The invoices shall include a summary as well as a detailed breakdown of the tasks, personnel, the hours and hourly rates.

#### **11. REGULATIONS**

The selected Consultant shall be expected to comply with all applicable federal, state, and township regulations and contract provisions.